

TECNICHE E APPLICAZIONI DEL DIAMANTE NATURALE E SINTETICO

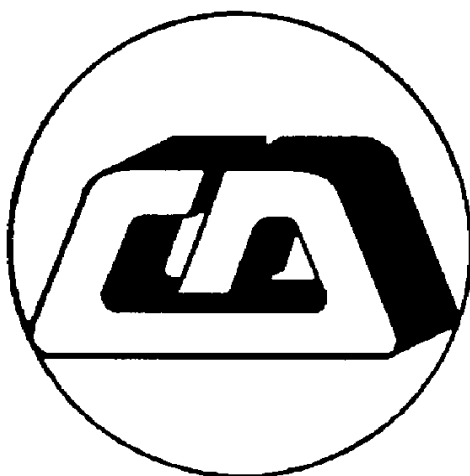

www.cidi-decarli.it

CATALOGO DIAMANTI RAVVIVAMOLE

gennaio 2010

aggiornamento 3.0

Ci. Di. di Decarli & C. Sas
Via del Mobiliere , 8
40138 BOLOGNA

Tel. 051 531027
Fax. 051 535396
e-mail: info@cidi-decarli.it

INDICE

| | |
|--|-----------|
| RAVVIVAMOLE MULTIPLI | 4 |
| MONOSTRATO | 4 |
| MULTISTRATO CILINDRICI | 4 |
| MULTISTRATO QUADRI | 4 |
| MULTISTRATO CON FORO PASSAGGIO REFRIGERANTE | 4 |
| INSERTI MULTISTRATO | 4 |
| INSERTI COLTELLO | 4 |
| | |
| RAVVIVAMOLE CIRCOLARI | 6 |
| CIRCOLARI MULTIFILA | 6 |
| CIRCOLARI MONOFILA | 6 |
| CIRCOLARI PUNTE SINGOLE | 6 |
| CIRCOLARI PUNTE SINGOLE CON DIAMANTI TRIANGOLARI | 6 |
| CIRCOLARI PER RAVVIVATURA MOLETTE INTERNI | 6 |
| | |
| RAVVIVAMOLE MANUALI | 8 |
| MANUALI CON DIAMANTE IN POLVERE | 8 |
| MANUALI MONOSTRATO CON PIETRE POSIZIONATE | 8 |
| MANUALI MULTISTRATO CON PIETRE POSIZIONATE | 8 |
| MANUALI MISTI PIETRE POSIZIONATE E POLVERE | 8 |
| | |
| RAVVIVAMOLE A CONCREZIONE DIAMANTATA | 10 |
| PASTIGLIE | 10 |
| CIRCOLARI | 10 |
| STICK PER RAVVIVATURA MANUALE | 10 |
| SETTORI PER RAVVIVATURA | 10 |
| | |
| RAVVIVAMOLE A DIAMANTE SINTETICO | 12 |
| SINGOLI | 12 |
| MULTIPLI | 12 |
| INSERTI TIPO COLTELLO | 12 |

| | |
|--|-----------|
| RAVVIVAMOLE A DIAMANTE SINGOLO NATURALE | 13 |
| SERIE MEDIA | 13 |
| SERIE HIGH | 13 |
| | |
| PROFILATORI CON PIETRE LAVORATE | 14 |
| PROFILATORI PER APPARECCHI DIAFORM | 14 |
| PROFILATORI CM1 | 14 |
| PROFILATORI AD INSERTO TIPO COLTELLO | 14 |
| DIAMANTI AFFILATI CONICI CON RAGGIO SFERICO | 15 |
| CIRCOLARI AFFILATI | 15 |

RAVVIVAMOLE MULTIPLI

MONOSTRATO

| codice | tipo | crt. | dimens. | pietre |
|--------|-------|------|---------|--------|
| 1001 | CDS10 | 1.00 | Ø13 | 6 |
| 1002 | CDS15 | 1.50 | Ø13 | 9 |
| 1003 | CDS20 | 2.00 | Ø13 | 12 |

SCHEMA POSIZIONAMENTO



MULTISTRATO CILINDRICI

| codice | tipo | crt. | dimens. | pietre x strati |
|--------|--------|------|---------|-----------------|
| 2001 | CDMS10 | 1.00 | Ø9x14 | 6 x 5 |
| 2002 | CDMS25 | 2.50 | Ø11x14 | 13 x 5 |
| 2003 | CDMS50 | 5.00 | Ø14x16 | 25 x 5 |

SCHEMA POSIZIONAMENTO

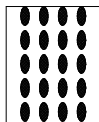

MULTISTRATO QUADRI

| codice | tipo | crt. | Dimens. | pietre x strati |
|--------|-------|------|--------------|-----------------|
| 3001 | CDM5 | 5.00 | 15 x 15 x 15 | 16 x 5 |
| 3002 | CDM3 | 5.00 | 15 x 15 x 15 | 9 x 5 |
| 3003 | CDM4 | 2.50 | 12 x 12 x 14 | 12 x 3 |
| 3004 | CDM6 | 2.00 | 10 x 10 x 10 | 16 x 3 |
| 3201 | CDM15 | 1.50 | 10 x 8 x 10 | 12 x 3 |
| 3202 | CDM20 | 2.00 | 15 x 5 x 15 | 10 x 6 |

SCHEMA POSIZIONAMENTO

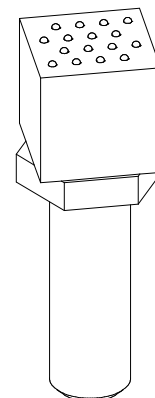
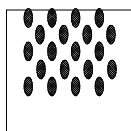

MULTISTRATO CON FORO PASSAGGIO REFRIGERANTE

| codice | tipo | crt. | Dimensioni | pietre x strati |
|--------|--------|------|------------|-----------------|
| 3501 | CDMF25 | 2.50 | 12x12x14 | 12 x 3 |

SCHEMA POSIZIONAMENTO

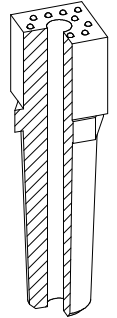

INSERTI MULTISTRATO

| codice | tipo | crt. | A x B x C | pietre x strati |
|--------|---------|------|-------------|-----------------|
| 4001 | CDUSP4 | 2.50 | 20 x 28 x 7 | 16 x 5 |
| 4002 | CDUS602 | 2.00 | 24 x 25 x 5 | 16 x 4 |

SCHEMA POSIZIONAMENTO

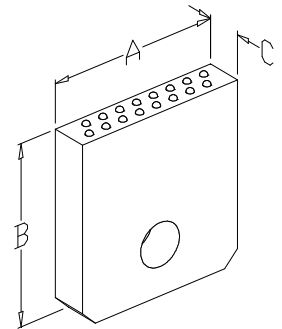
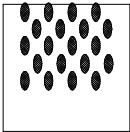

INSERTI COLTELLO

| codice | tipo | A x B x C | Pietre x strati |
|--------|---------|-------------|-----------------|
| 5001 | CD107 | 10 x 28 x 5 | 5 x 4 |
| 5002 | CD107/S | 10 x 28 x 5 | 6 x 4 |
| 5201 | CD507 | 15 x 28 x 5 | 5 x 4 |
| 5202 | CD512 | 15 x 28 x 5 | 8 x 4 |
| 5401 | CD205 | 20 x 30 x 5 | 7 x 4 |
| 5402 | CD207 | 20 x 30 x 5 | 11 x 4 |
| 5403 | CD212 | 20 x 30 x 5 | 12 x 5 |
| 5404 | CD212/S | 20 x 30 x 5 | 14 x 6 |
| 5505 | CD215 | 20 x 30 x 5 | 7 x 5 |

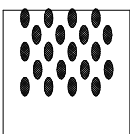

SCHEMA POSIZIONAMENTO

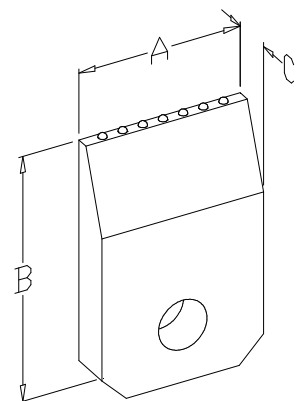

RAVVIVAMOLE CIRCOLARI

CIRCOLARI MULTIFILA

| codice | tipo | dimens. | n° pietre | strati |
|--------|--------|----------|-----------|--------|
| 101 | CD16 | Ø18x8 | 30 | 4 |
| 102 | CD20 | Ø18x8 | 24 | 4 |
| 121 | CD24 | Ø21x9 | 30 | 4 |
| 122 | CD24/S | Ø21x9 | 24 | 4 |
| 141 | CD26 | Ø21x10.5 | 48 | 6 |
| 142 | CD26/S | Ø21x10.5 | 48 | 6 |

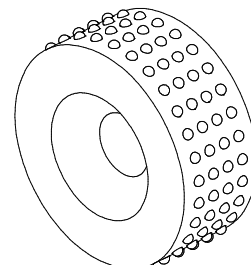

CIRCOLARI MONOFILA

| codice | tipo | dimens. | n° pietre |
|--------|---------|---------|-----------|
| 201 | CD04/21 | Ø21x4.5 | 48 |
| 202 | CD05 | Ø21x4.5 | 46 |
| 203 | CD07/21 | Ø21x4.5 | 40 |
| 221 | CD04 | Ø25x4.5 | 64 |
| 222 | CD07/S | Ø25x4.5 | 40 |
| 241 | CD04/30 | Ø25x4.5 | 72 |
| 242 | CD07/30 | Ø30x4.5 | 48 |

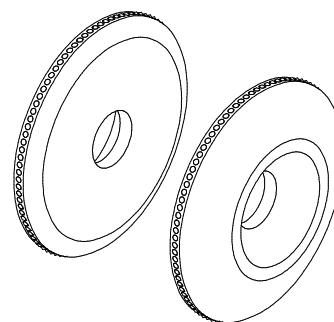

CIRCOLARI PUNTE SINGOLE

| codice | tipo | crt. | dimens. | n° pietre |
|--------|--------|------|---------|-----------|
| 301 | CD15 | 1.00 | Ø17x6 | 6 |
| 302 | CD15/S | 1.20 | Ø17x6 | 6 |
| 303 | CD15/8 | 1,20 | Ø17x6 | 8 |
| 321 | CD23 | 1.50 | Ø19x6 | 6 |
| 341 | CD30 | 2.00 | Ø20x6 | 8 |

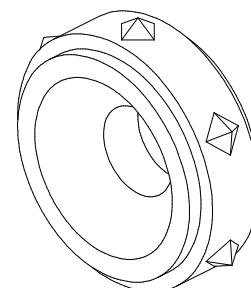

CIRCOLARI PUNTE SINGOLE CON DIAMANTI TRIANGOLARI

| codice | tipo | crt: | dimens. | n° pietre |
|--------|-----------|------|---------|-----------|
| 401 | CD8001C/P | 1.00 | Ø25x5 | 8 |
| 402 | CD6001C/P | 1.00 | Ø25x5 | 6 |

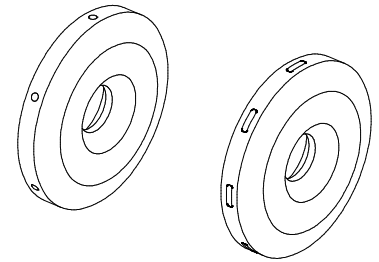

SCHEMA POSIZIONAMENTO

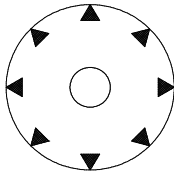

TIPO P

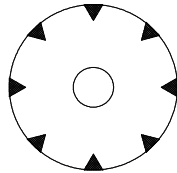

TIPO C

CIRCOLARI PER RAVVIVATURA MOLETTE INTERNI

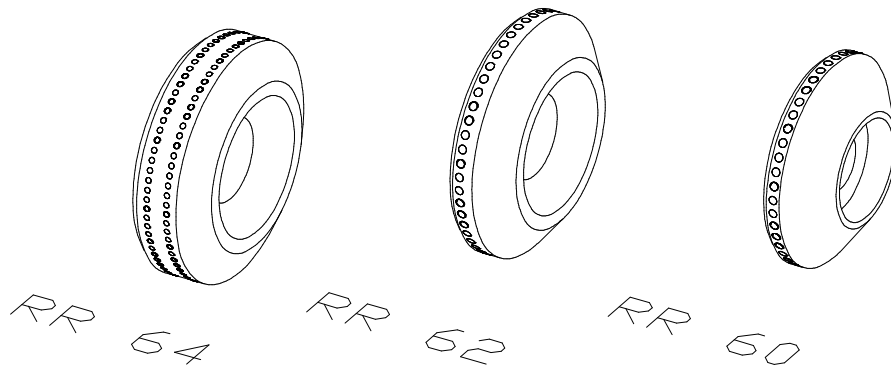

| codice | tipo | Dimens. | n° pietre | file |
|--------|---------|---------|-----------|------|
| 601 | CD 01 S | Ø15x4 | 46 | 1 |
| 621 | CD 01 | Ø17x4 | 57 | 1 |
| 641 | CD 08 | Ø17x5 | 57 | 2 |

RAVVIVAMOLE MANUALI SERIE

MANUALI CON DIAMANTE IN POLVERE

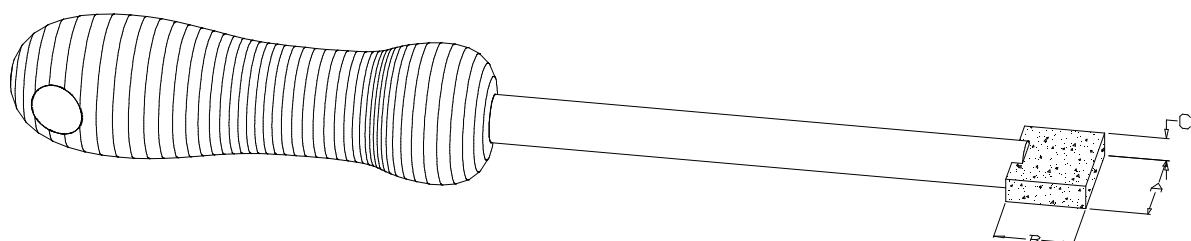

| codice | crt. | A x B x C |
|---------|------|-----------|
| RHC 250 | 2.50 | 20x12x4.5 |
| RHC 400 | 4.00 | 20x15x4.5 |
| RHC 600 | 6.00 | 20x18x4.5 |

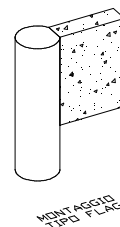

MONTAGGIO
TIPO FLAG

MANUALI MONOSTRATO CON PIETRE POSIZIONATE

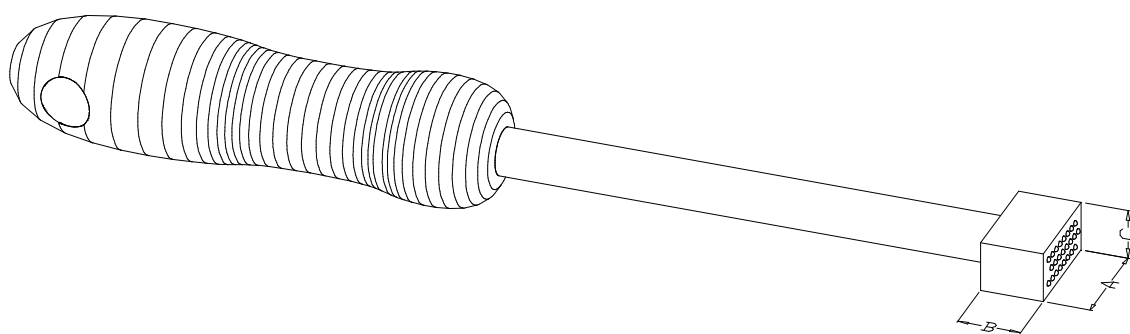

| codice | crt. | A x B x C | n° pietre |
|--------|------|-----------|-----------|
| RH 100 | 1.00 | 15x9x12 | 12 |
| RH 200 | 2.00 | 20x10x12 | 24 |
| RH 400 | 4.00 | 24x12x15 | 40 |

MANUALI MULTISTRATO CON PIETRE POSIZIONATE

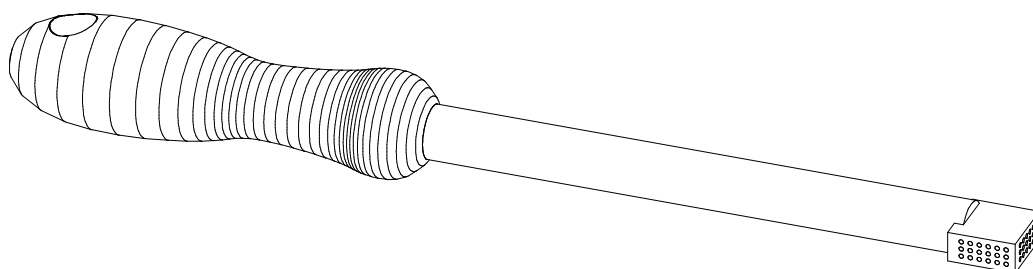

| codice | crt. | A x B x C | n° pietre |
|--------|------|-----------|-----------|
| RHP 10 | 1.50 | 15x7x15 | 23 |

SCHEMA POSIZIONAMENTO

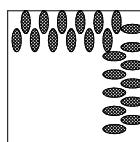

MANUALI MISTI PIETRE POSIZIONATE E POLVERE

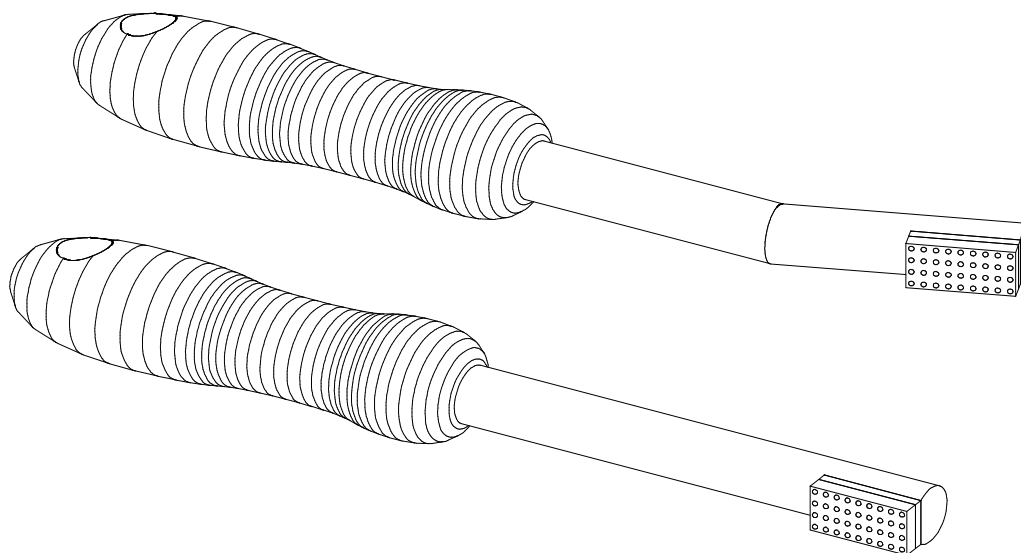

| codice | crt. | Dimens. | n° pietre | strati |
|--------|------|-----------|-----------|--------|
| RHP 20 | 1.00 | 20x10x3+2 | 36 | 1 |

**RAVVIVAMOLE CON DIAMANTE IN POLVERE
SERIE ST***

PASTIGLIE

| codice | crt. | dimens. |
|---------|------|---------|
| STC 100 | 1.00 | Ø5x8 |
| STC 200 | 2.00 | Ø7x8 |
| STC 300 | 3.00 | Ø8.5x8 |
| STC 400 | 4.00 | Ø10x8 |
| STC 500 | 5.00 | Ø11x8 |

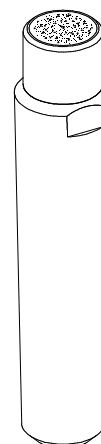

CIRCOLARI

| codice | crt. | dimens. |
|--------|------|---------|
| STR 20 | 3.00 | Ø21 x 3 |
| STR 22 | 4,00 | Ø21 x 6 |

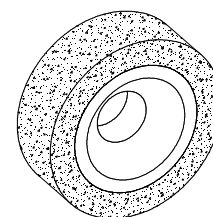

STICK PER RAVVIVATURA MANUALE

| codice | concentr. | crt. | grana | dimens. |
|--------|-----------|------|-------|---------|
| STB 30 | C125 | | D151 | 6x8x40 |
| STB 30 | C125 | | D213 | 6x8x40 |

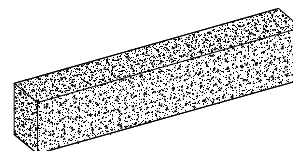

SETTORI PER RAVVIVATURA

| codice | concent. | grana | dimens. |
|--------|----------|-------|----------|
| STP 40 | C100 | D711 | 20x6x8+3 |
| STP 40 | C100 | D427 | 20x6x8+3 |
| STP 40 | C100 | D213 | 20x6x8+3 |
| STP 50 | C100 | D711 | 15x6x8+3 |
| STP 50 | C100 | D427 | 15x6x8+3 |
| STP 50 | C100 | D213 | 15x6x8+3 |
| STP 60 | C100 | D711 | 10x5x8+3 |
| STP 60 | C100 | D427 | 10x5x8+3 |
| STP 60 | C100 | D213 | 10x5x8+3 |

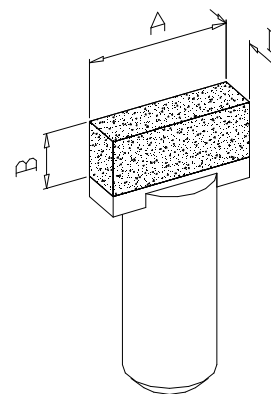

RAVVIVAMOLE SINTETICI CVD - MD

SINGOLI

| codice | n°pt | dim. pt |
|--------------|------|------------|
| CVD o MD 815 | 1 | 53x0.8x0.8 |

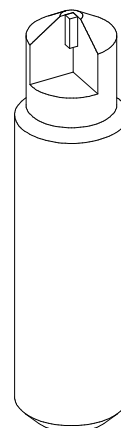

MULTIPLI

| codice | n°pt | dimensioni pt |
|--------------|------|---------------|
| CVD o MD 825 | 2 | 5x0.8x0.8 |
| CVD o MD 835 | 3 | 5x0.8x0.8 |
| CVD o MD 845 | 4 | 5x0.8x0.8 |
| CVD o MD 855 | 5 | 5x0.8x0.8 |

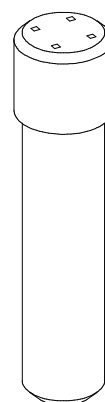

INSERTI TIPO COLTELLO

| codice | n°pt | dimensioni pt |
|--------------|------|---------------|
| CVD o MD 815 | 1 | 5x0.8x0.8 |
| CVD o MD 825 | 2 | 5x0.8x0.8 |
| CVD o MD 835 | 3 | 5x0.8x0.8 |
| CVD o MD 845 | 4 | 5x0.8x0.8 |
| CVD o MD 855 | 5 | 5x0.8x0.8 |

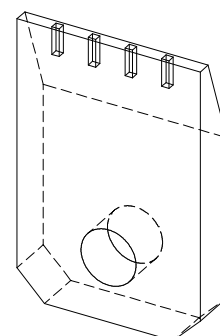

RAVVIVAMOLE PIETRE SINGOLE

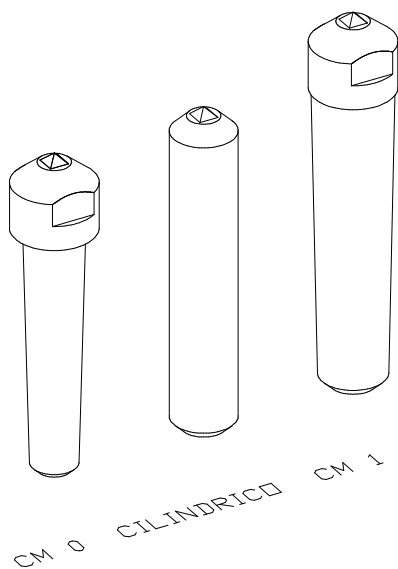

SERIE MEDIA

| Codice | crt: |
|--------------|------|
| Singolo 010M | 0.10 |
| Singolo 015M | 0.15 |
| Singolo 020M | 0.20 |
| Singolo 030M | 0.30 |
| Singolo 050M | 0.50 |
| Singolo 075M | 0.75 |
| Singolo 100M | 1.00 |
| Singolo 150M | 1.50 |
| Singolo 200M | 2.00 |
| Singolo 300M | 3.00 |

SERIE HIGH

| codice | crt: |
|--------------|------|
| Singolo 030H | 0.30 |
| Singolo 050H | 0.50 |
| Singolo 075H | 0.75 |
| Singolo 100H | 1.00 |
| Singolo 150H | 1.50 |

PROFILATORI CON PIETRE LAVORATE

PROFILATORI PER APPARECCHI DIAFORM

| codice | A° | R |
|----------|-----|-------|
| DF 40125 | 40° | 0.125 |
| DF 40250 | 40° | 0.250 |
| DF 40500 | 40° | 0.500 |
| DF 60125 | 60° | 0.125 |
| DF 60250 | 60° | 0.250 |
| DF 60500 | 60° | 0.500 |

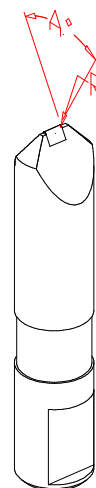

PROFILATORI CM1

| codice | A° | R |
|-----------|-----|-------|
| DFS 60125 | 60° | 0.125 |
| DFS 60250 | 60° | 0.250 |

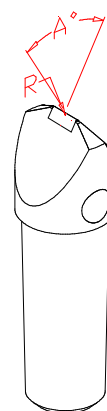

PROFILATORI AD INSERTO TIPO COLTELLO

| codice | A° | R |
|-----------|-----|-------|
| DFK 40200 | 40° | 0.200 |

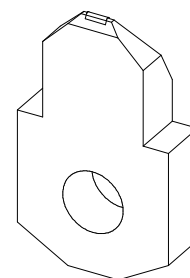

DIAMANTI AFFILATI CONICI CON RAGGIO SFERICO

| codice | angolo | raggio |
|----------|--------|--------|
| OP 60250 | 60 | 0.250 |

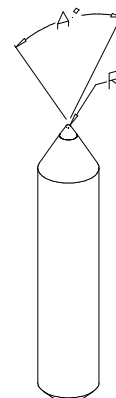

CIRCOLARI AFFILATI

| codice | tipo | dimensioni | N° pietre | strati |
|--------|------|------------|-----------|--------|
| RR 70 | 60° | Ø25x4 | 36 | 1 |

Note: Costruiamo utensili speciali per qualsiasi tipo di applicazione in base alle necessità del cliente.